



Code 502701

Original Instructions

Router Elevator

Fast accurate height adjustment from above the table



AT: 04/07/2024
BOOK VERSION: 14

INDEX OF CONTENTS

Copyright	02
What's included	03-04
Specifications	04
Accessories	04
Dimensions Position Diagram	05
Illustration & Description of the Router Elevator	06-07
Fitting the Router and the Cutters	08-09-10-11
Setup/Operating Instructions	11
Maintenance	12
Exploded Diagrams/Lists	13-14-15

COPYRIGHT

**This product has been wholly designed by UJK Limited who have exclusive use of the design.
As such it should not be copied or reproduced.**



Please dispose of packaging for the product in a responsible manner. It is suitable for recycling. Help to protect the environment, take the packaging to the local recycling centre and place into the appropriate recycling bin.

The symbols below advise the correct safety procedures when using this machine.

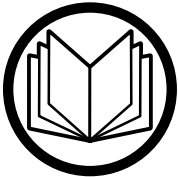

Fully read manual and safety instructions before use



Ear protection should be worn

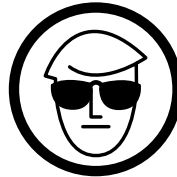

Eye protection should be worn



Dust mask should be worn

EXPLODED DIAGRAMS/LISTS

26	9180404018A	Key	M4 x 4 x 12	5
27	9236804Z0	Ball Bearing	6804ZZ	5
28	60700009B	Crank Handle Sleeve		1
29	9236900Z0	Ball Bearing	6900ZZ	6
30	903M06030	Flat Head Cap Screw	M6x30	2
31	60700020	Chain		1
32	919S01000	C-Ring	S10	4
33	917M03018	Lock Pin	M3 x 18	3
34	60100018	Insert Wrench		1
35	910M06000	Hex Nut	1/4"	4
37	60700005	Eccentric Rod		1
38	60700012	Brake Gear		1
39	60700006	Lock Arm Spacer		1
40	60700013	Lock Arm		1
41	914M061301	Flat Washer	M6	1
42	901M06030	Hex Socket Cap Screw	M6 x 30	1
43	94300002	O-Ring	1242 x 178	1

EXPLODED DIAGRAMS/LISTS

Index	Part No	Description	Size	Qty
1	60700001	Aluminum Carriage Bracket		1
2	60500002	Main Gear Shaft		1
3	60500003	Lead Screw		4
4	60100017	Insert Ring		1
5	60500005	Gear Shaft		4
6	60500006	Upper Guide Nut		1
7	60700008	Upper Guide Nut Base		1
8	60700007	Top Table		1
8A	60700031	Starter Pin		1
8B	906M06025	Round Head Screw	M6 x 25	1
9	60500009	Cam Gear		1
10	60700010	Wheel Elliptic		1
11	912M14000	Nylon Nut	M14	1
12	60500012	Chain Gear		4
13	60700017	Base		1
14	60700001	Upper Guide Nut		1
15	60500015	Master Ring		1
16	60500016	Master Ring Clamp		4
17	60700009	Lift Handle		1
18	60700003	Spring		1
19	60700018	Scale Plate		1
20	908M06006	Set Screw	M6 x 6	9
21	923688ZZ	Ball Bearing	688ZZ	1
22	9236805Z0	Ball Bearing	6805ZZ	5
23	901M08020	Hex Socket Cap Screw	M8 x 20	1
24	903M06018	Flat Head Cap Screw	M6 x18	12
25	903M04012	Flat Head Cap Screw	M4 x12	4

WHAT'S INCLUDED

Quantity	Item		Model Number
1 No.	Router Elevator with Measurement Dial (router mounting plate and table Insert fitted)	A	502701
1 No.	Winding Handle	B	
1 No.	Packet containing:-		
2 No.	M6 x 30mm Countersunk Bolts	C	
1 No.	Nippled 'Y' wrench (for Table Insert)	D	
4 No.	Hex Keys 6mm/4mm/3mm/2.5mm	E	

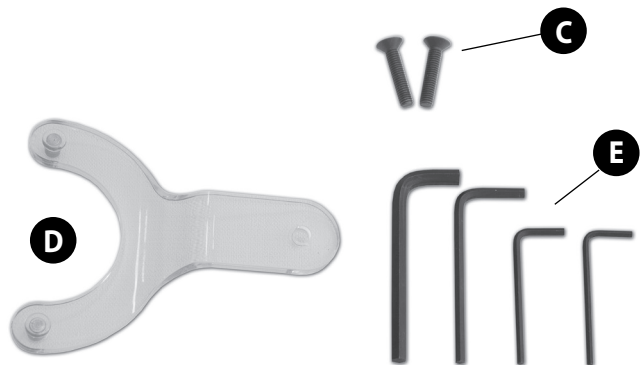
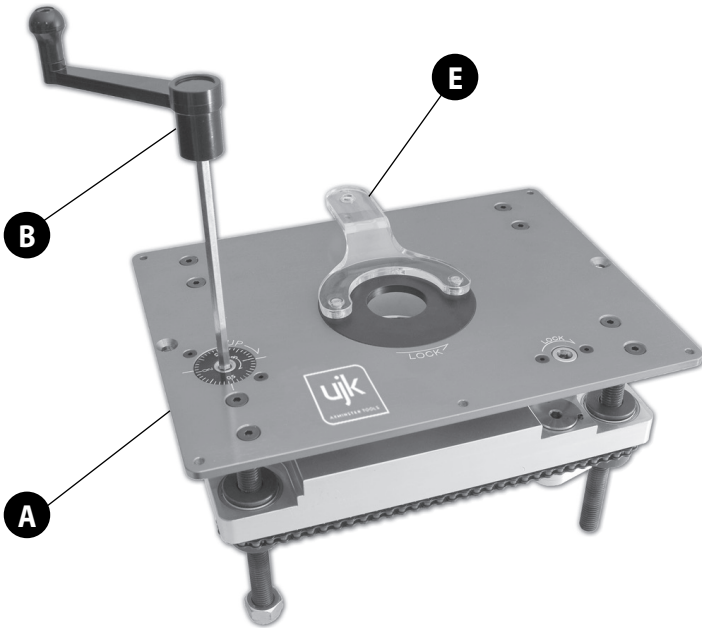

WHAT'S INCLUDED

Having unpacked your machine and its accessories, please check the contents against the equipment list "What's in the box", if there are any discrepancies, please contact Axminster Tool Centre using the procedures laid down in the catalogue. Please dispose of the packaging responsibly; much of the material is bio-degradable.

Please read the Instruction Manual prior to using your new tool; there are daily and periodic maintenance

recommendations to help you keep your machine on top line and prolong its life. Keep this Instruction Manual readily accessible for any others who may also be required to use the machine.

Please read through the section entitled Identification and Description of Parts, so that you will be familiar with the terminology we will use in the manual, and so that you can identify the parts quickly and easily.

SPECIFICATIONS

Code	502701
Machine Table Size	306mm x 229mm x 6mm
Rise and Fall Platform Size:	275mm x 200mm
Router Mounting Plate	Circular Universal Type
Maximum Rise and Fall	100mm
Rise and Fall Linear Movement per turn	2mm
Floating Measurement Dial Graduation	0.125mm
Centre Hole Diameter (Without insert ring)	92mm
Centre Hole Diameter in Insert Ring	38mm
Centre Hole in Rise and Fall Platform	75mm
'Lost' Cutter Length (from router mounting plate to machine table)	14.5mm
Overall Size L x W x H	L 306mm x W 229mm x H 165mm
Weight	6 kg

ACCESSORIES



Axcaliber Router Collet Extension (1/2" Shank)
(Code: 211367)

Note: The Assembly requires a through table void of 280mm x 205mm. The recess for the Machine Table is 306mm + 229mm + 6mm + deep. The dimensions and the position are shown on the next page (See Fig A)

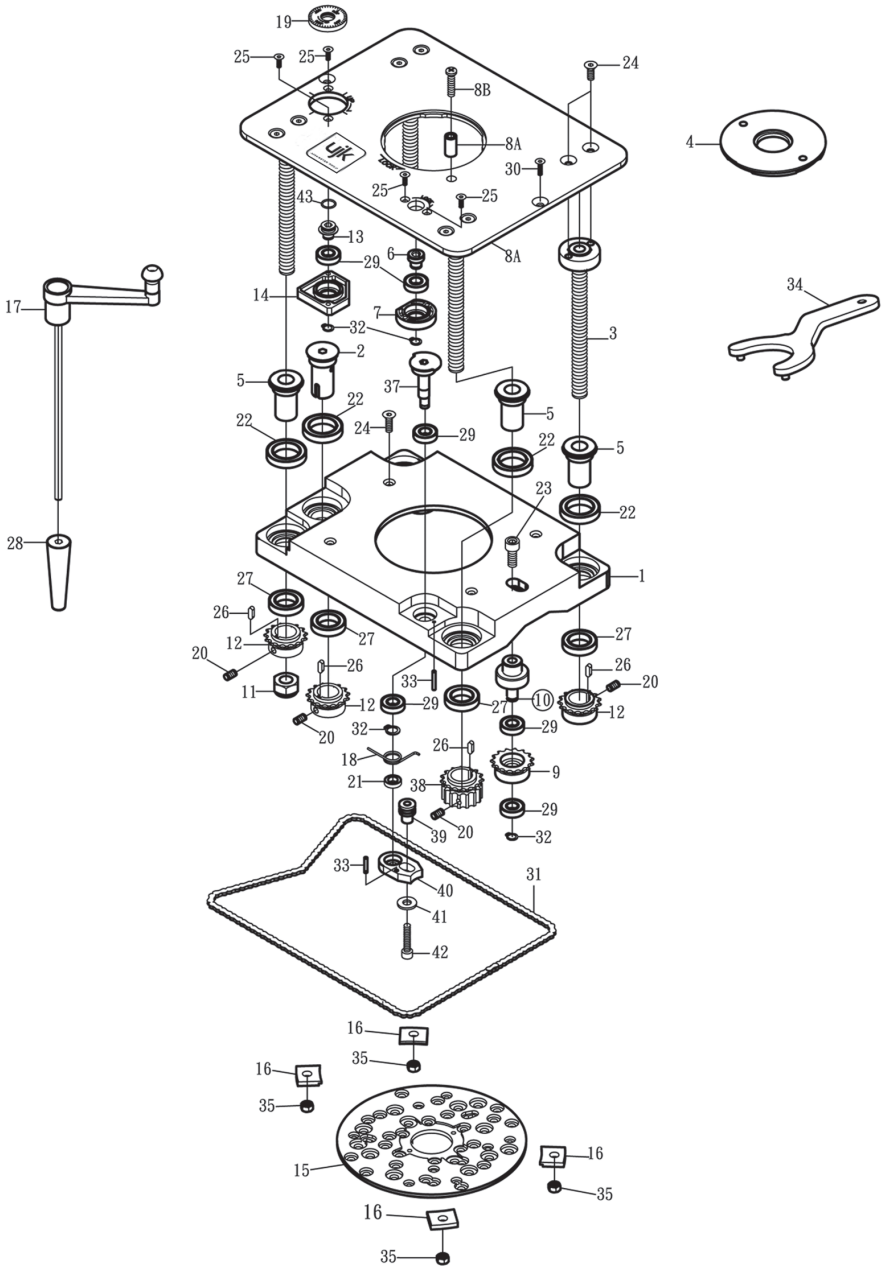

MAINTENANCE

The router elevator requires minimum maintenance, but you are advised to observe the following points:-

- 1. Keep** the elevator clean. Ensure that dust/chips etc., are cleaned away at the end of a work session.
- 2. Do not** allow a build up of dust/chips etc., between the machine table and the rise and fall platform, or under the machine, where it may foul the chain drive.
- 3.** If the winding action becomes '**lumpy**' check that there is no debris caught in the chain, or compressed onto a sprocket.
- 4. Check** the chain tension. If the chain has become 'slack' or loosened, re-tension by adjusting the idler sprocket. **Do not over tension**, the chain needs to be firm, with a small side to side movement (best checked on a 'long' side) it does not need to be rigid. (See Figs 5 and 6)
- 5. Remember!** A chain is a machine as well, give it a light lube.

Fig 5

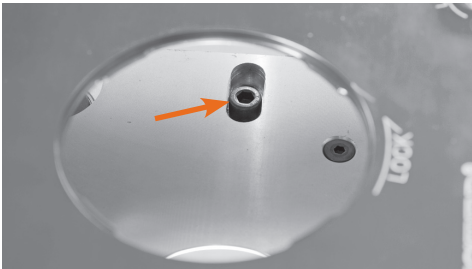

Loosen the idler sprocket bolt, using a 6mm Hex key and adjust the sprocket until the chain is firm

Fig 6

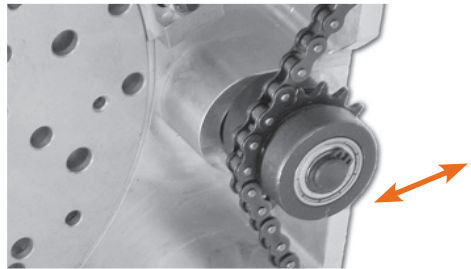

idler sprocket

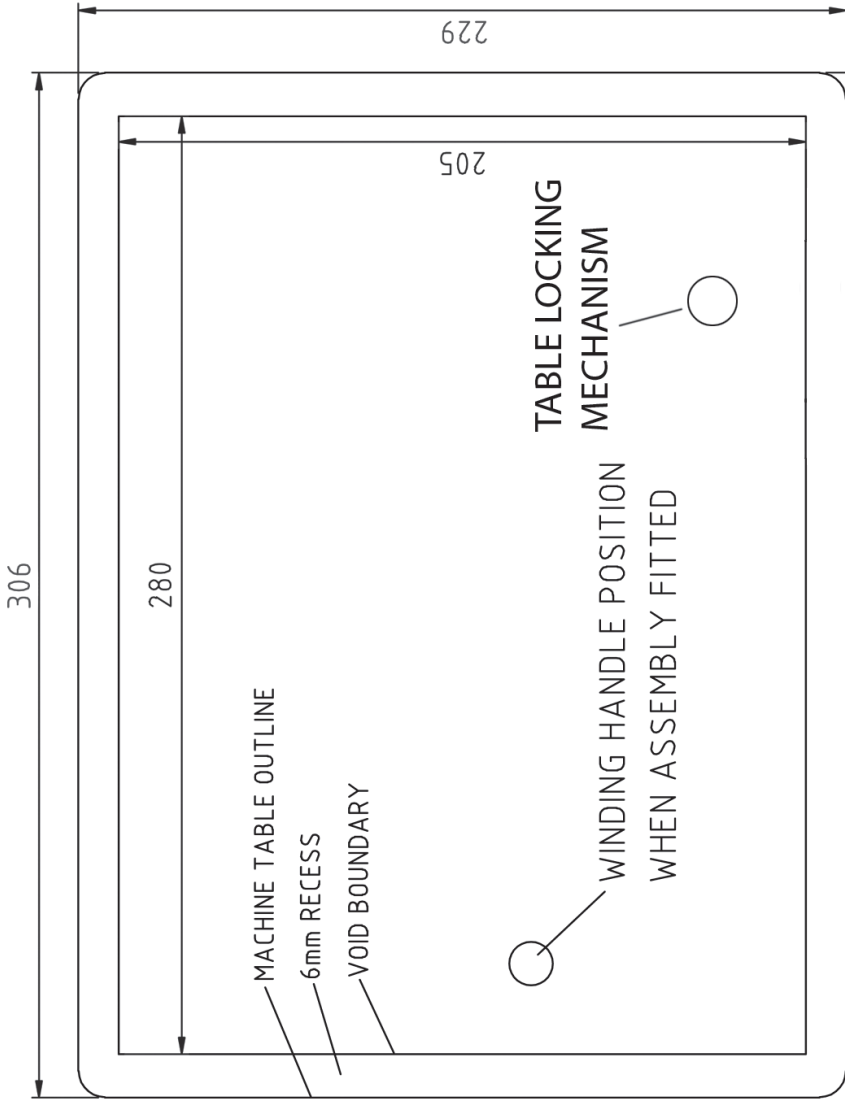
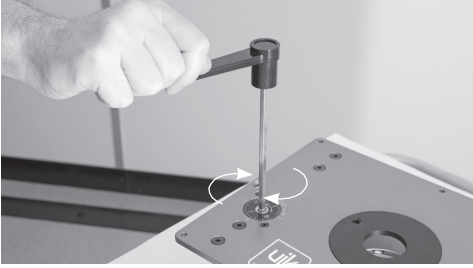
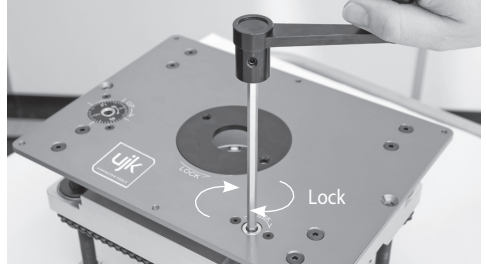

FIG.A

ILLUSTRATION & DESCRIPTION OF THE ROUTER ELEVATOR



Turn the handle clock-wise to raise the table



Locking the table in position

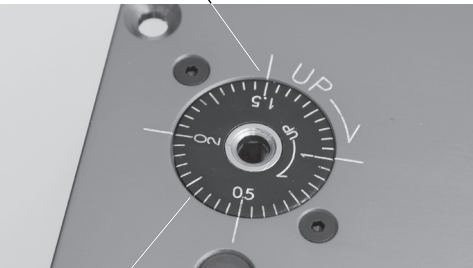
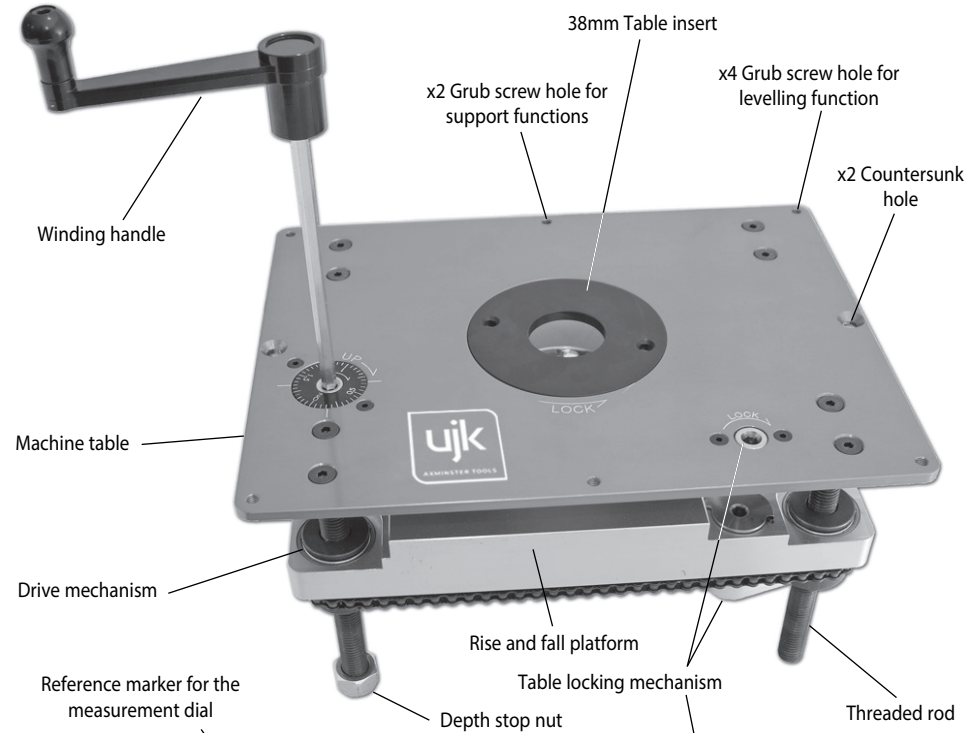

Measurement dial



FITTING THE ROUTER AND THE CUTTERS

NOTE. If you find that some of your cutters are 'borderline' for 'reach' or the length of shank remaining in the collet is approaching the minimum limit, may we suggest the purchase of the short collet extension Axminster No. **211367**. (See Page 4)

NOTE. If you are not using a professional router table with a remote On/Off switching facility, or a Power Tool NVR Switch, remember to orientate the router so that the

power switch is easily accessible when the router elevator is fitted to the work platform.

When everything is assembled to your satisfaction. Check the speed setting of the router is correct for the cutter diameter. Give the router a 'quick burst' to check that everything is secure. If the 'quick burst' check is O.K. Proceed to fit your fencing, dust extraction etc

SETUP/OPERATING INSTRUCTIONS

Ensure you have identified all the parts of your Router Elevator.

Place the Router Elevator into the prepared recess. (See Fig A on page 05). Check that it is flush with the work platform surface. If this is not the case insert the supplied grub screws in the threaded corner holes and level the machine table. (See Fig 4) If, for some reason, it is impossible to level the table absolutely flush with the work platform, ensure

that the 'front' of the table is low in the recess, and the 'rear' of the table is high to the work surface. (Low and High in this instance refer to the minimal measurements required to ensure that there is no 'edge' for the work piece to 'snag' on). When you are satisfied with the levelling process you can, if required, fasten the elevator in position with the two M6 bolts supplied or even two Wood Screws. (perhaps an MDF working platform/table?).

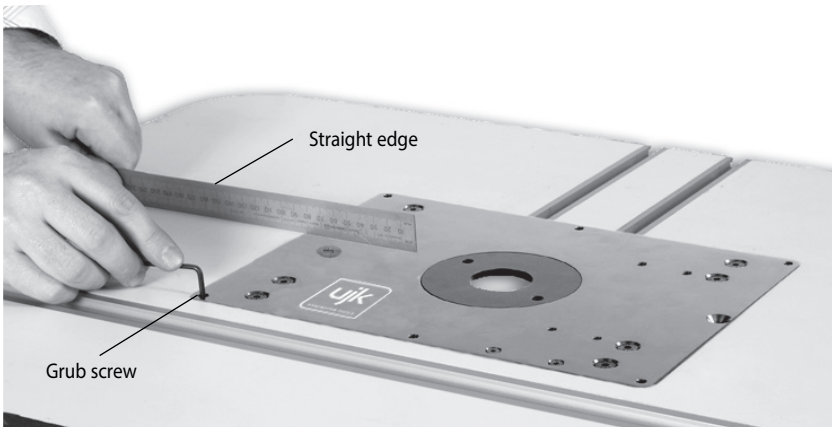

Fig 4

FITTING THE ROUTER AND THE CUTTERS



IN ORDER TO FIT SOME OF THE ROUTERS TO THE ELEVATOR AND ACHIEVE UNRESTRICTED MOVEMENT, IT MAY BE NECESSARY TO REMOVE THE HANDLES; PLUNGE THE ROUTER BODY TO DEPTH, ETC.

Lower the table to almost its fullest extent. Using the Allen key provided loosen the bolts and therefore the lugs holding the universal mounting plate (UMP) in position and remove. (See Figs 1 and 2). Remove the sole plate from your router, see illustrations 1 to 2 and secure your router to the UMP via the appropriate holes, see pages 8-9. Insert the requisite tool into the router and tighten securely.

Adjust the 'depth' of the router to give the slightly more than the required exposure of the tool (to allow for adjustment) and lock the body. Remember that you will lose 14.5mm of the set 'height' of the cutter between the lower face of the universal mounting plate and the upper surface of the machine table. Alternatively, current practise would indicate that the router is plunged to maximum depth and all height adjustment is done using the elevator. Refit the mounting plate to the rise and fall platform. (See Fig 3)

Fig 1

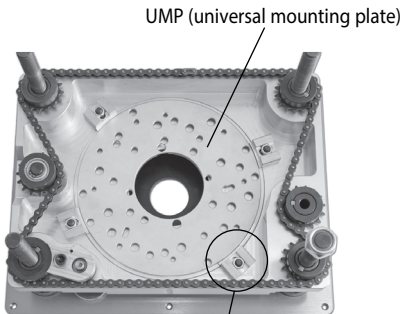
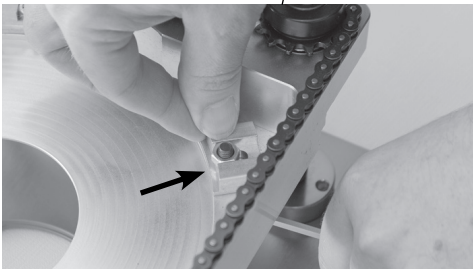

Fig 2



Mounting plate holding down lug

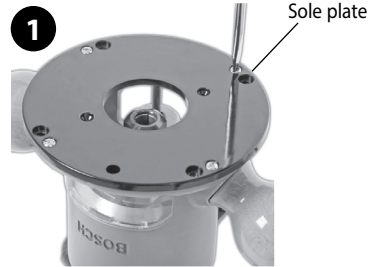

Fig 3



Router/mounting plate mounted in the router elevator

Please note: Removing the router handles will prevent them from interfering with the chain.

Re-fasten the holding lugs. If the router tool diameter is greater than 75mm, the router/mounting plate combination must be refitted to the rise and fall platform first, and then the tooling mounted into the router. (Hint. You will find this easier with the rise and fall platform at its highest position and the table insert removed).

ILLUSTRATION & DESCRIPTION OF THE ROUTER ELEVATOR



Insert the Nippled "Y" wrench into the table insert and turn un-clockwise to remove the insert



Remove the table insert and place safely aside

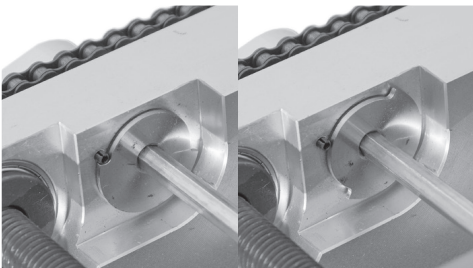
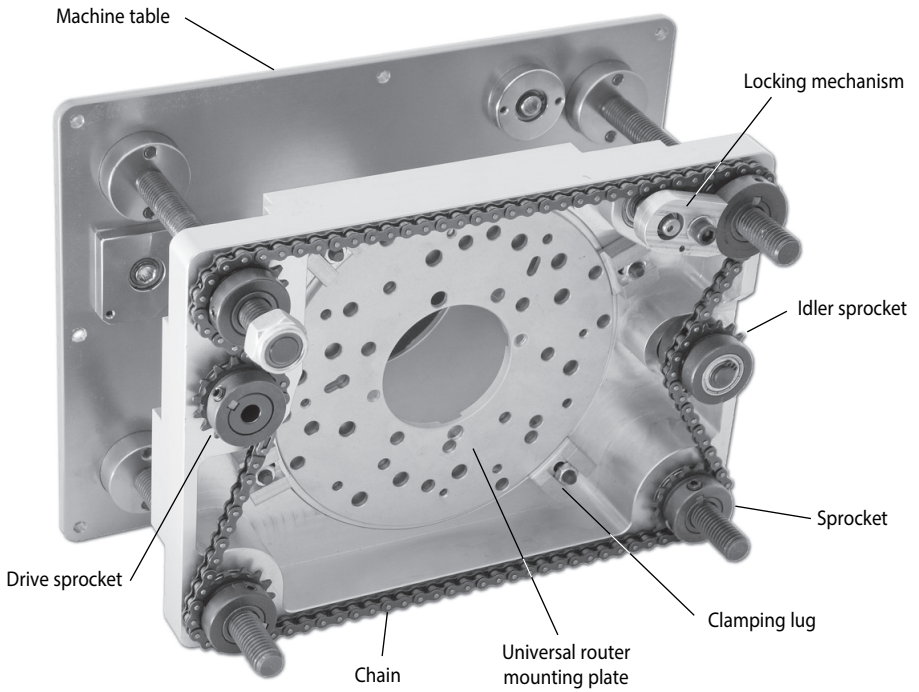
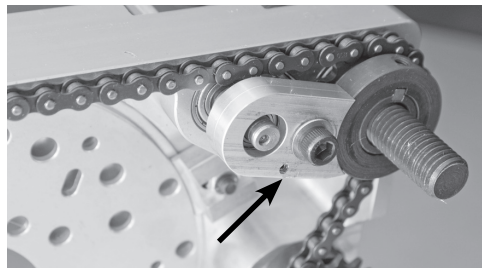

Table locked

Table un-locked



Locking mechanism



FITTING THE ROUTER AND THE CUTTERS

INTRODUCTION

The information below is reproduced from the Axminster universal base plate fitting instructions and the hole layout on the router elevator base plate is identical. Hole numbers, screw types and how many required are given for mounting

different router models to the router elevator base plate. For advice on models suitable for fitting to the router elevator please contact our experts on **03332 406 406**

Please note: Some of the router's listed in this chart may not be suitable for use with the router elevator.

	New switch regulations means NVR Switch cannot be used!
	Handles may need to be removed!



BOSCH	1700ACE POF52	1	Fx2
	400,500A,600ACE	3	Fx2
	POF800ACE.GOF900A <2003	4	Gx3
	GOF1300ACE,900A>2003	5	Gx3
	GMF1400	0	Ix4
CMT	CMT1E, CMT2E	1	Fx2
DEWALT	DW613, 614, 615, 620, 621, DW625EK.629, DW625EK, DW625KT	1	Fx2
DRAPER	R1900V	2	Fx3
	PT1200V	1	Fx3
ELU	OF97(E), MOF177(E), 131,98, MOF77,96(E) MK2,69'	1	Fx2
FELISATTI	R346EC	1	Ex2
FESTOOL	OF2000(E)	7	Ex3
	OF1E,900(E), 1000(E), OF1010	8	Bx4 & Ax3
	OF1400 EBQ-Plus	23	H2
FREUD	FT1000(E), 2000E	2	Fx3
HITACHI	M8(V)	10	Dx4
	M12V, M12SA	11	Dx4
	TR12	11-12	Dx4

HIKOKI	M12VE	11	Dx4
MAFELL	L050E	8	Bx4
	L065EC	3	Dx2
	L055	21&2	Dx2
MAKITA	3620, 3612BR, 3600B	13	Dx2
	3612(C)	14	Ex2
	RP0910, RP1110C, RP1111C	1	Fx2
	RP2301FC, RP230FC	22	Bx4
PRO	CLM1250R >11/03, CLM2050R	1	Fx2
PERLES	OF808(E)>1999', 2-808(E), OF9(E)	1	Hx2
PEUGEOT	DEF570E.DF55E	15	Ex2
RYOBI	RE600N, R600N, RE601, ERT1500V	13	Dx2
	R500,502	16	Ax4
	R150, 151, RE120, 155K	15	Ex2
SKIL	1835U.1875U1	17	Cx3
TREND	T3, T4, T5, T5EK, T5MK2',T9, T10, T11 (T14 has own NVR switch)	1	Hx2
	Not suitable for the Models below (T7EK, T7, T12)		
TRITON	MOF001 TRA001	21 2 5	1/4" UNC 6.35mm
WADKIN	R500	16	Ax4

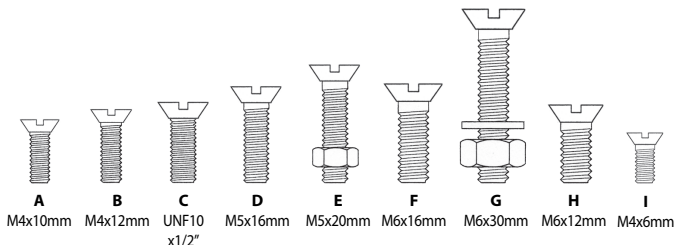

UNIVERSAL BASE PLATE

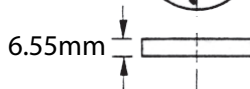
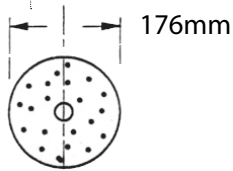
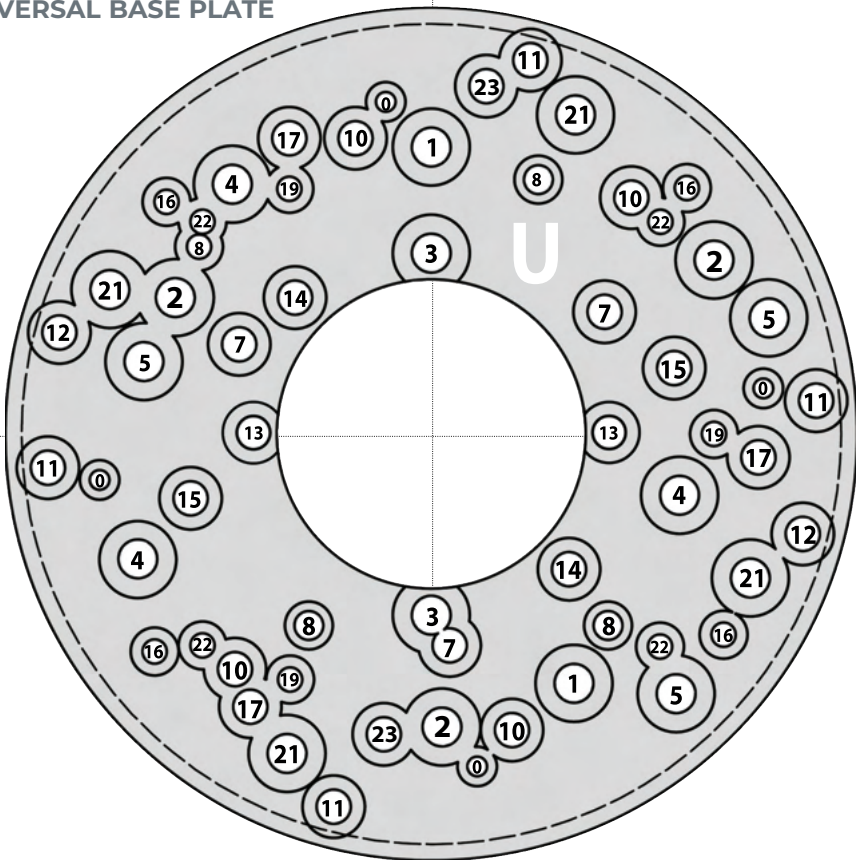

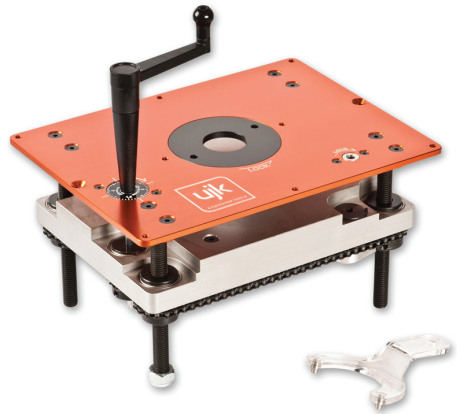
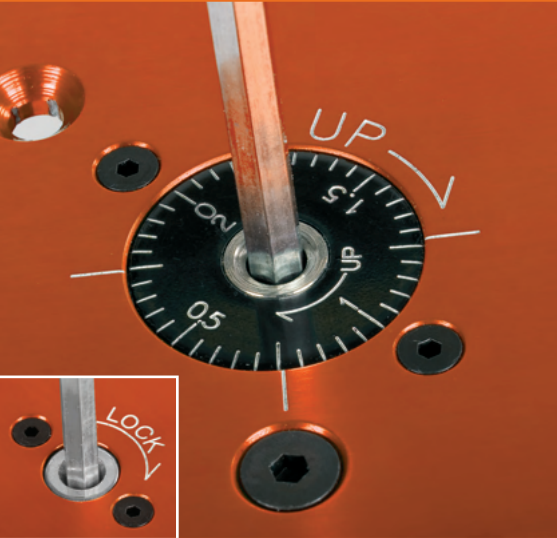

UJK, Axminster, Devon, EX13 5PH

ujktools.com